

## About Tilisi

Tilisi is an integrated, mixed use development on 400 acres of land located in Limuru, Kiambu County some 25 km from Westlands.

Tilisi is a development by Tilisi Developments PLC whose mission is to develop, manage and maintain Tilisi as a development that re-defines the essence of business, lifestyle and leisure.

Tilisi offers a quality corporate and community experience in an outstanding, well managed development that provides state-of-the-art infrastructure, high quality facilities and urban amenities including public open spaces, excellent landscaping, schools, medical facilities and retail centres.

Tilisi is one of the first master planned developments that is consciously designed as a 15 minute city, reducing dependency on vehicles and promoting access to home, workplaces and amenities through a short walk or cycle.

All land at Tilisi is fully serviced with connections to power, water, water borne sewerage and ICT. And through the application of Tilisi's sophisticated development controls and guidelines, property owners at Tilisi are assured of a development where value is sustained.



## Great Location

Westlands (27km), Gigiri, Karen, Lavington and the CBD (30km) are all highly accessible from Tilisi, giving the location the benefits of being well connected but also away from the noise and pollution of the city.

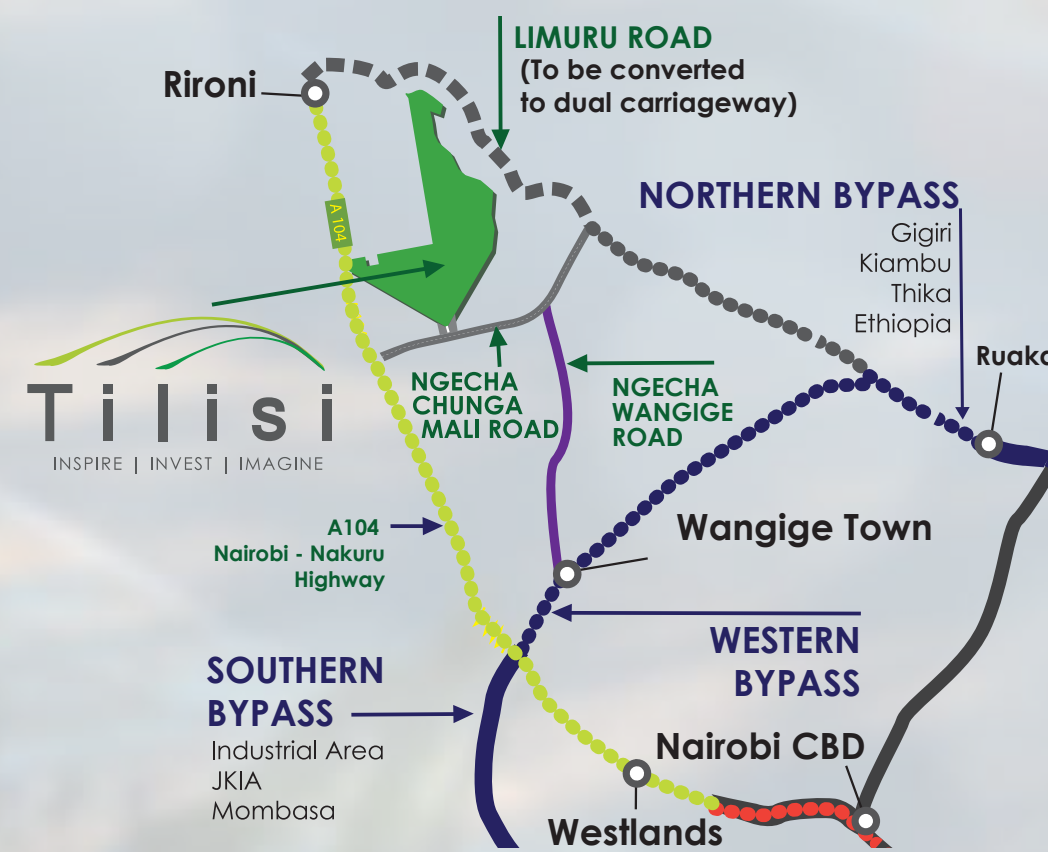

Tilisi Developments PLC, Ngecha Chunga Mali Road, Off A104 (Nairobi - Nakuru Highway), P.O.Box 39542-00623, Nairobi, Kenya.

Tilisi Woods: +254 (0) 781 828 914

[tilisiwoods@tilisi.co.ke](mailto:tilisiwoods@tilisi.co.ke) [www.tilisi.co.ke](http://www.tilisi.co.ke)

Fully Serviced Half Acre plots



## About Tilisi Woods

Following on the success of Tilisi Views, Tilisi Developments PLC brings you Tilisi Woods - an exclusive, high end residential estate. Tilisi Woods offers fully serviced half acre land parcels where property owners develop their own homes in a safe, secure, and sustainable environment. Leveraging off its location in Tilisi, Tilisi Woods promotes walkability and access to natural green spaces and sets the benchmark for the quality of the environment, infrastructure and amenities. With four house designs to choose from, Tilisi Woods offers exclusive living in the serenity of Tilisi.



The architecture of the designs captures the spirit of place - contemporary with a country feel in the rolling hills of Limuru overlooking the Tigoni Tea farms. To ensure the vision of the development is realised, buyers at Tilisi Woods get a choice of four housing typologies, developed to concept design stage which can be modified to suit the lifestyle of the owner. The concept designs set the tone and theme of Tilisi Woods.

Welcome to Tilisi Woods - Quality Living at another level!



## Tilisi Woods Masterplan

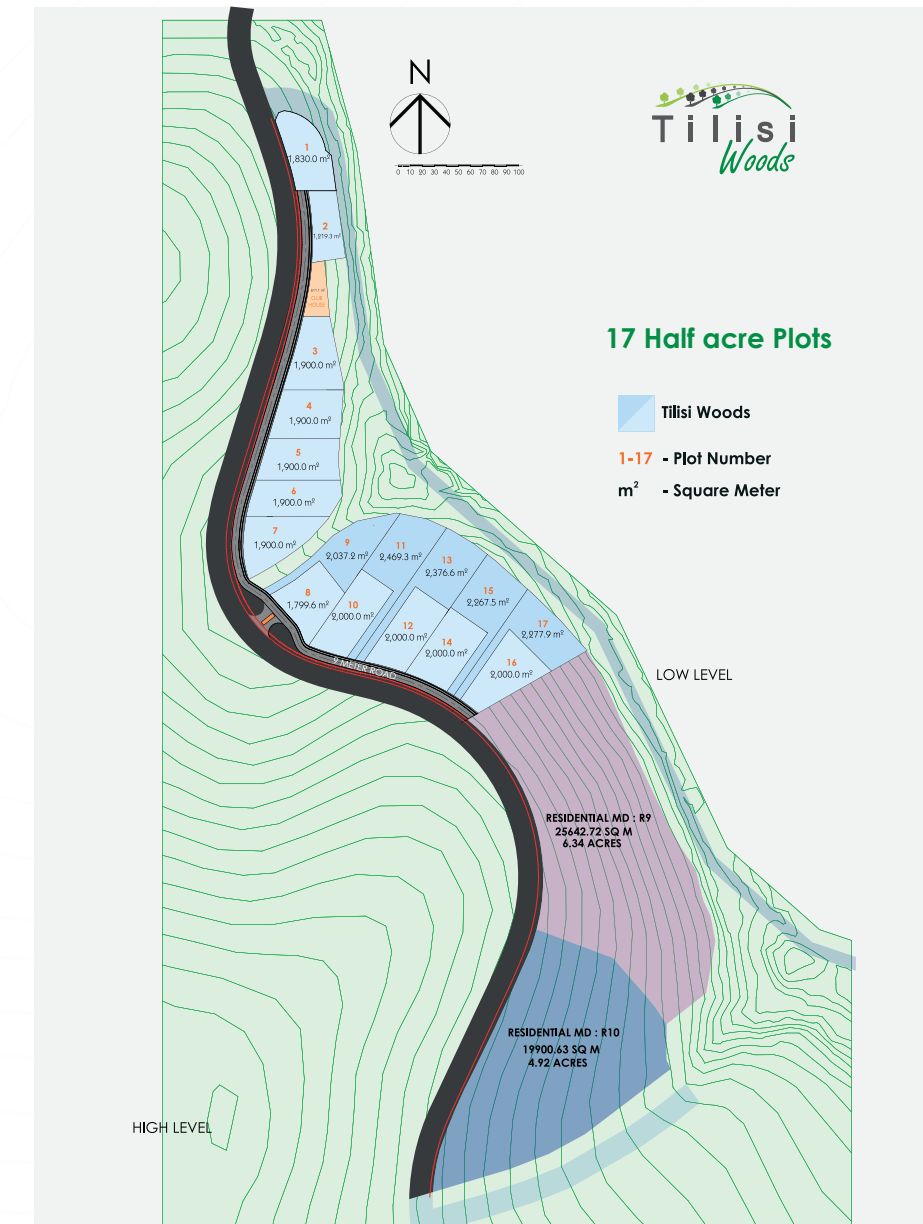

## Tilisi Masterplan

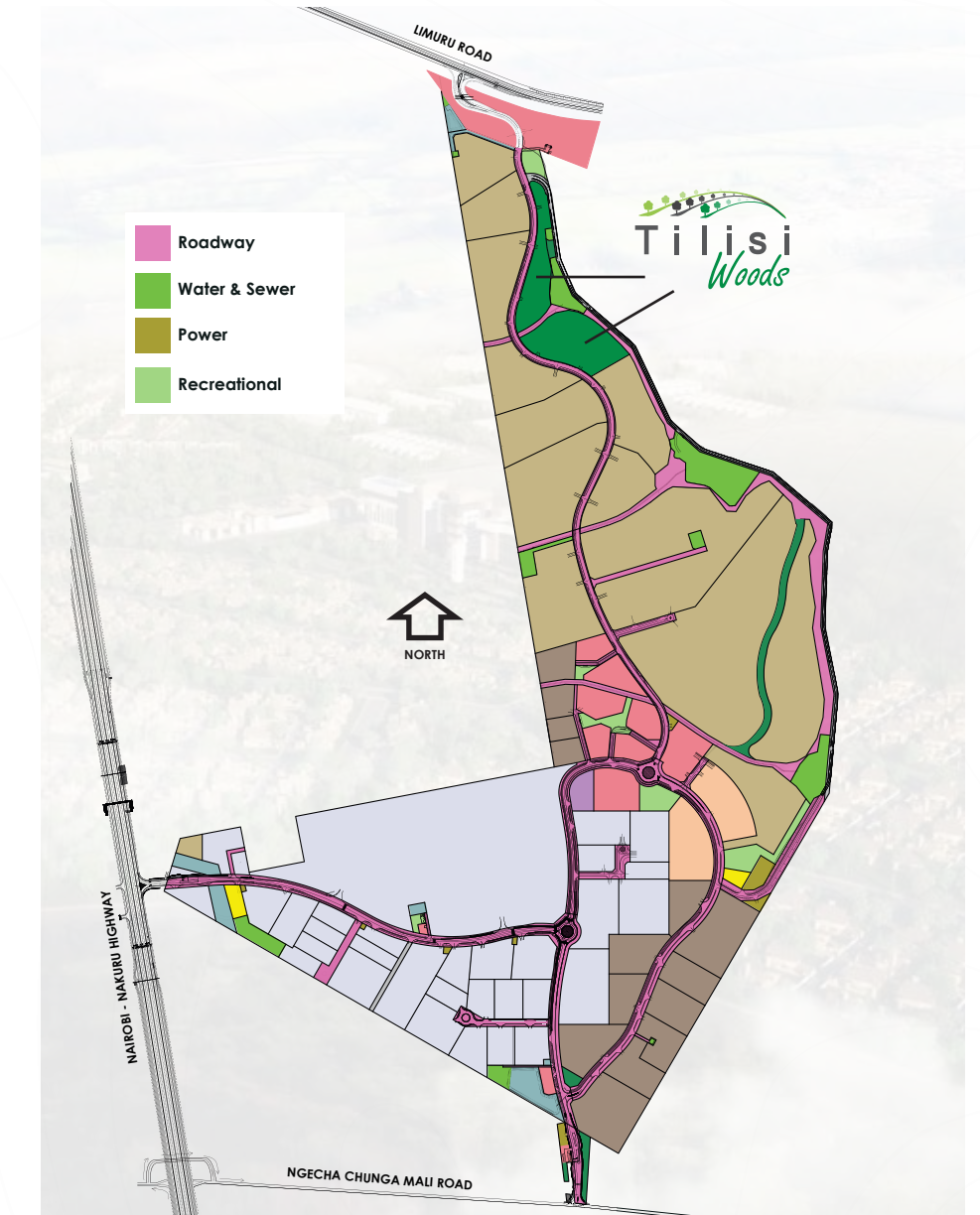

## Four exquisite designs to choose from

### Oak House



The 431 m<sup>2</sup> Oak House can accommodate open plan living, 5 bedrooms, all with ensuite bathrooms, and large living and entertainment spaces.



### Acacia House



The 524 m<sup>2</sup> Acacia House sits over 4 levels, with a large entertainment area opening to the garden at the lower ground level. It can accommodate 5 en-suite bedrooms with terraces overlooking the views.



### Tree Lodge



Tree Lodge is two units - one of 420 m<sup>2</sup> and one of 444 m<sup>2</sup> - one above the other. Together they accommodate 9 en-suite bedrooms. Each unit has room for open plan living, large entertainment areas and family rooms.



### Cedar House



The 5 bedroomed, 408 m<sup>2</sup> Cedar House can accommodate a large entertainment area on the lower ground floor that opens to the garden, open plan living, family rooms and terraces.



### Amenities at Tilisi Woods



Fully serviced plots



Power



Water



water borne sewerage



ICT



Gate house



security



Clubhouse accessing the natural open spaces with gym, heated pool and entertainment areas